

Poleplate 190

Mounting and installation products E-mobility
Charging box mount - Pole plate
NEXT GREEN - POLEPLATE 190

next  green

Model

E Number:
27 013 84

Product name:
Charging box mount Poleplate 190



Technical specifications

Material
Color

Steel, powder coated
Graphite grey

Dimensions
Weight
Height
Width

2,0 kg
405 mm
191 mm

Packaging dimensions
Weight
Height
Width
Depth

2,5 kg
590 mm
235 mm
90 mm

POLE PLATE 190 FEATURES

- Precut hole pattern to suit NexBlue EV-charger
- For mounting on a Ø 60 mm steel tube
- Robust steel construction
- Powder coated, available in various colors. Contact Next Green for more information

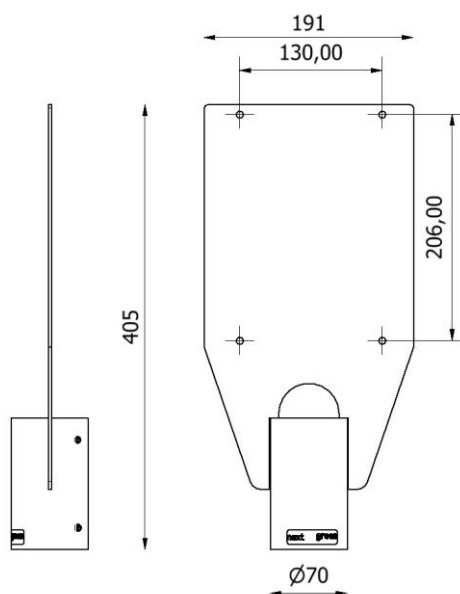

SELECTION OF COMPATIBLE EV-CHARGERS

- NexBlue Edge 2, Edge Max, Delta and Delta Max

Next Green Poleplate 190 is a charger mount for installation on a Ø 60 mm pole. Poleplate is made of Swedish steel and powder coated to provide the highest durability and quality. Poleplate enables easy mounting of a charging box to a steel tube.

Poleplate is manufactured in Sweden for the Nordic climate. It has a powder-coated design to withstand wind and weather. The Poleplate charging box holder is a cost-effective pole mount.

Poleplate 190 facilitates changing an engine heater station to a charging station and can be used to replace an engine heater central.